

SKF LAGG AF

Air driven grease pumps

SKF LAGG 18AF



SKF LAGG 50AF



SKF LAGG 180AF



Table of contents

- Safety precautions 3
- EU Declaration of Conformity 4
- UK Declaration of Conformity 4
- 1. Application..... 5
- 2. Description 5
- 3. Technical data 5
- 4. Operating instructions 6
 - 4.1 General preparation.....6
 - 4.2 Minimum recommended air quality.....6
 - 4.3 Operation of air-driven grease pumps LAGG 18AF, LAGG 50AF and LAGG 180AF.....7
- 5. After use..... 8
- 6. Storage..... 8
- 7. Transportation 8



- Do replace worn or damaged parts with genuine SKF parts.
- Do use lubricating greases within the recommended NLGI grades.

READ THIS FIRST

Safety precautions

Read this instruction for use fully. Follow all safety precautions to avoid personal injury or property damage during equipment operation. SKF cannot be responsible for damage or injury resulting from unsafe product use, lack of maintenance or incorrect equipment operation. In case of any uncertainties as regards the use of the equipment contact SKF.

Failure to comply with the following could cause equipment damage and personal injury.

- Do ensure that the equipment is only operated by trained personnel.
- Do wear proper personal protective gear, such as eye protection, protective gloves and safety shoes, when operating the equipment.
- Do inspect the equipment and all accessories carefully before use.
- Do not use damaged components or modify the equipment.
- Do not use the equipment above the stated maximum pressure.
- Do not use the pumps with accessories, which are rated below the maximum working pressure of the pump.
- Do not use damaged hoses. Avoid sharp bends and kinks when connecting hoses. Sharp bends and kinks will internally damage the hose leading to premature failure. Applying pressure to a damaged hose may cause it to rupture.
- Do not lift the equipment by the hoses or couplings.
- Do follow local safety regulations.
- Do service the equipment by a qualified technician or SKF Repair Centre.

EU Declaration of Conformity LAGG AF

We, SKF MPT, Meidoornkade 14,
3992 AE Houten, The Netherlands herewith
declare under our sole responsibility that the
products described in these instructions for
use, are in accordance with the conditions of
the following legislations:

MACHINERY DIRECTIVE 2006/42/EC
and are in conformity with the following
standards:

EN ISO 12100:2010, DIN EN 809 :1998+A1:2009,
EN ISO 4414:2010

Houten, The Netherlands, December 2025



Jérôme Verrier
Manager Quality and Compliance



UK Declaration of Conformity LAGG AF

We, SKF MPT, Meidoornkade 14,
3992 AE Houten, The Netherlands herewith
declare under our sole responsibility that the
products described in these instructions for
use, are in accordance with the conditions of
the following legislations:

Supply of Machinery (Safety) Regulations 2008
(2008 No. 1597)

and are in conformity with the following
standards:

EN ISO 12100:2010, DIN EN 809 :1998+A1:2009,
EN ISO 4414:2010

The person authorised to compile the technical
documentation on behalf of the manufacturer is
SKF (U.K.) Limited, 2 Canada Close, Banbury,
Oxfordshire, OX16 2RT, GBR.

Houten, The Netherlands, December 2025



Jérôme Verrier
Manager Quality and Compliance



1. Application

Description		LAGG 18AF	LAGG 50AF	LAGG 180AF
Operation	air driven	X	X	X
Drum size	18 kg	X		
	50 kg		X	
	180 kg			X
Grease type	NLGI class 0 – 2	X	X	X
Hose	2,1 m (7 ft)	X	X	X
Air inlet/pump outlet connection				
	1/4" (F) BSP	X	X	X
Trolley included		X		
Optional trolley	LAGT 18-50F		X	
Optional trolley	LAGT 180F			X

2. Description

LAGG 18AF, LAGG 50AF and LAGG 180AF

These grease pumps are designed for high-pressure applications.

The LAGG 18AF is suitable for use with standard SKF 18 kg drums.

The LAGG 50AF is suitable for use with standard SKF 50 kg drums.

The LAGG 180AF is suitable for use with standard SKF 180 kg drums.

These pumps must be connected to a supply of compressed air. The pump supplies grease when the handle is squeezed. The flow of grease stops when the handle is released.

The LAGG 18AF is equipped with a trolley.

3. Technical data

For air driven pumps				
Description	LAGG 18AF	LAGG 50AF	LAGG 180AF	
Maximum air pressure	10 bar (150 psi)	10 bar (150 psi)	10 bar (150 psi)	
Minimum air pressure	2 bar (30 psi)	2 bar (30 psi)	2 bar (30 psi)	
Pressure ratio	50:1	50:1	50:1	
Maximum grease output pressure	500 bar (7 500 psi)	500 bar (7 500 psi)	500 bar (7 500 psi)	
Suitable drum: inside diameter	265 – 288 mm (10.4 – 11.3 in)	350 – 380 mm (13.8 – 15 in)	576 – 602 mm (22.6 – 23.7 in)	
Suitable drum: maximum inside height	390 mm (15.3 in)	680 mm (26.7 in)	900 mm (35.4 in)	
Weight	16.9 kg (37.2 lb)	9.4 kg (20.7 lb)	15.1 kg (33.3 lb)	

4. Operating instructions

4.1 General preparation

For all models

Contaminant will cause severe wear and ultimately failure of the pump.

Prevent that the piston rod is (temporarily) placed on a dirty surface at any time.

1. Remove the lid of the grease drum.
2. Place the follower plate on top of the grease in the drum. Push the follower plate down until the grease is visible through the centre opening of the plate.
3. Fit the cover plate on top of the drum.
4. Tighten the three screws to secure the top to the drum. Ensure that the cover plate is centred and securely fixed to the drum.
5. Insert the piston rod of the pump mechanism through the cover plate and the follower plate. Ensure that the piston rod penetrates all the way to the bottom of the drum.
6. Secure the piston rod to the cover plate by tightening the two screw.

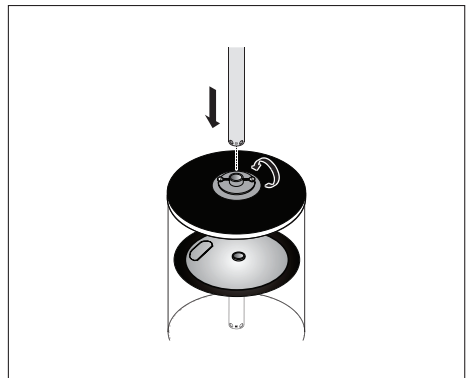
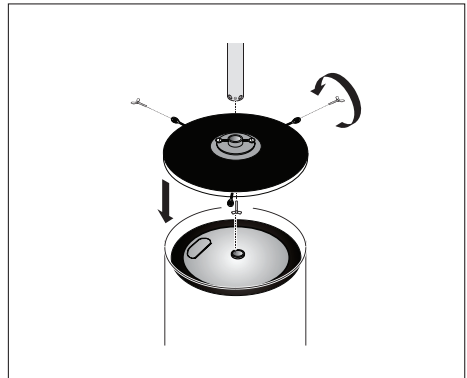
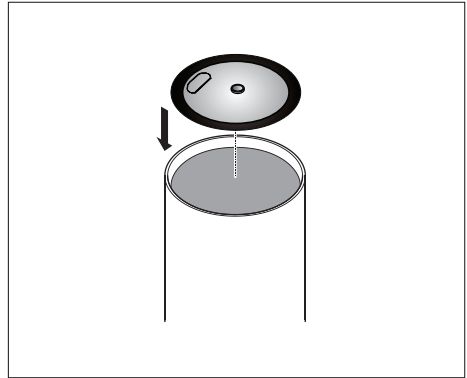

4.2 Minimum recommended air quality

The air quality should as a minimum satisfy the following conditions;

ISO 8573.1:2001 Compressed air -- Part 1:
Contaminants and purity classes.

Solid particle: Class 4

Water: Class 4 or better depending on the ambient temperature.
(A water vapour pressure dew point at least 10 °C below the ambient temperature is recommended)

Oil: Class 5

4.3 Operation of air-driven grease pumps LAGG 18AF, LAGG 50AF and LAGG 180AF

For LAGG 18AF only

Assemble the trolley and put the grease drum on the base. The trolley can also be used for a 50 kg drum.

Trolley assembly:

1. Insert holder assembly (9) & clamp (5) onto the handle (3).
2. Lock the trolley in place using toe lock (10) and insert the handle (3) into the groove provided on the trolley base plate (1).
3. Secure the handle (3) on the trolley base plate (1) using grub nut (6).
4. The pump is tightened by using the knob (8). When not using the holder assembly (9), the grease pail can still be secured by using the clamp (5).

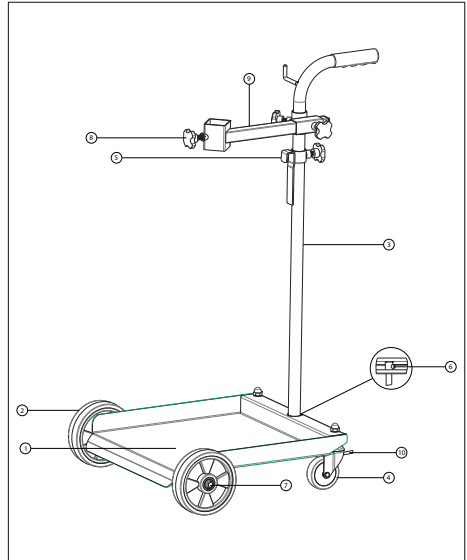

For all air driven grease pumps

1. Connect the grease delivery hose to the grease pump.
2. Check that all of the connections are attached securely.
3. Check that none of the hoses are damaged. Replace any damaged hoses immediately.
4. Connect the air inlet hose to the air inlet port on the grease pump. Ensure that the inlet air pressure does not exceed 10 bar (150 psi). Installation of an air pressure regulator on the air inlet is recommended to increase the working life of the grease pump mechanism.

The grease pump must be connected to a clean and dry air supply. An unfiltered air supply can cause the pump to stall or stop.

5. Squeeze the grease gun handle until grease is discharged from the outlet.
All of the air has now been removed and the grease pump is ready for use.

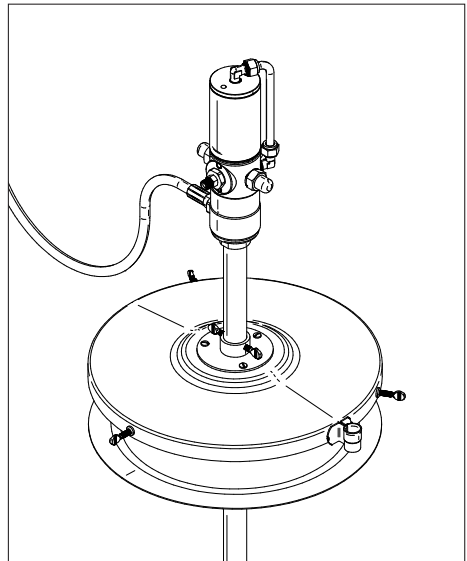

5. After use

For all air driven grease pumps

1. Disconnect the air inlet hose.
2. Release the pressure from the grease pump by operating the grease gun handle.
3. Transfer any possible grease residue to the next grease drum.
4. Dispose of waste grease in an environmentally friendly manner.

6. Storage

Dry place without dust, storage in a well-ventilated dry room

- Shelf life: max. 24 months
- Relative humidity: < 65 %
- Storage temperature: +10 ... +40 °C
- No direct sunlight or UV radiation
- Protection from nearby sources of heat or cold

7. Transportation

Products should be carried out in the carrying case provided by SKF in all instances regardless of distance.

In order to ensure proper protection of the products during transportation, reloading and storage, they must be packed in their carrying cases or other packaging materials that protect the product from damage and loss.



skf.com • skf.com/mapro

® SKF is a registered trademark of the SKF Group.

© SKF Group 2025

The contents of this publication are the copyright of the publisher and may not be reproduced (even extracts) unless prior written permission is granted. Every care has been taken to ensure the accuracy of the information contained in this publication but no liability can be accepted for any loss or damage whether direct, indirect or consequential arising out of the use of the information contained herein.

MP5536 EN · 2025/12